

INVERTER MONOFASE

POSSIBILITA' DI COLLEGAMENTO ALLA RETE (CEI-021)

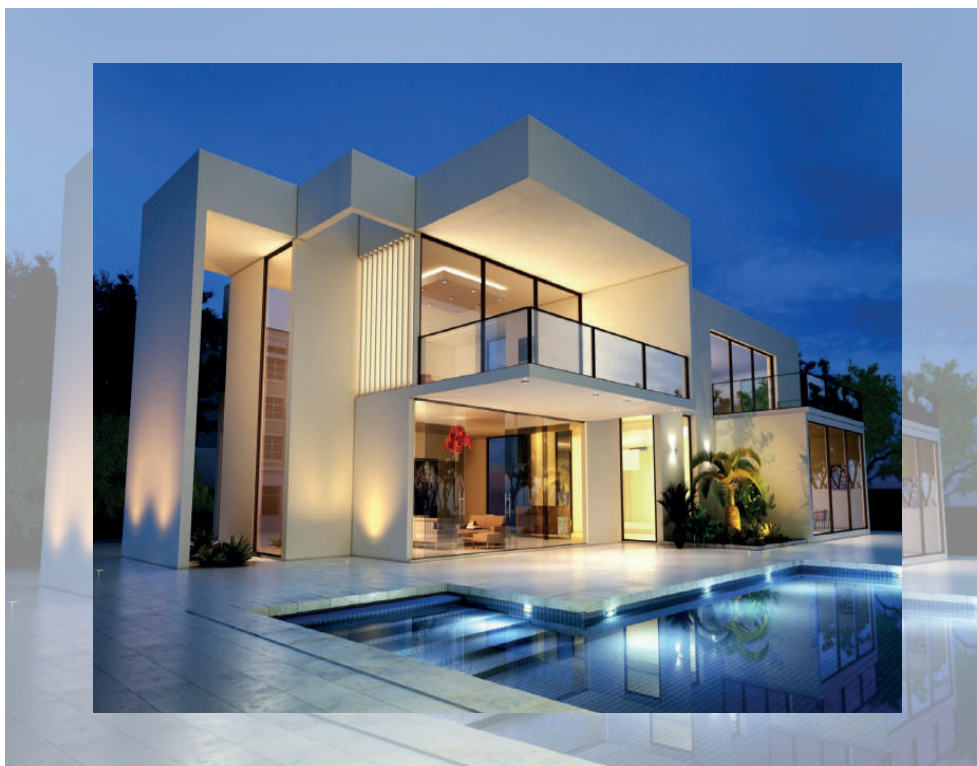

ANTI-FLOW
Funzione blocco corrente in uscita.



INGRESSO MAX C/C
Potenza massima Pannelli 1,5 della potenza Inverter



PROTEZIONE
Protezioni Intelligenti



SMART
Scansione Intelligente della curva I-V



WIFI
Integrato



CONFIGURAZIONE
Semplice tramite WIFI



MODBUS

CARATTERISTICHE

Efficienza MPPT > 99,9%.

2 MPPT.

Compensazione della potenza attiva/reattiva e regolazione del fattore di potenza.

Il raffreddamento con circolazione naturale dell'aria.

Installazione facile e veloce.

Potenza di uscita di alta qualità e basso THDI.

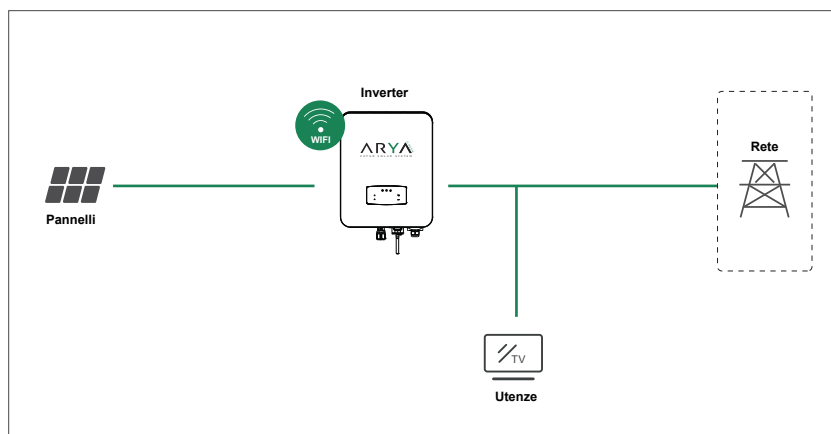

INVERTER MONOFASE

HNS1000TL-1 / HNS3000TL / HNS4000TL / HNS6000TL

PV Input Data	HNS1000TL-1	HNS3000TL	HNS4000TL	HNS6000TL
Max. DC Power (W)	1500	4500	6000	8400
Max. DC Voltage (V)	600	600	600	600
MPPT Voltage Range (V)	50-500	70-550	70-550	70-550
MPPT Full Power Voltage Range (V)	70-500	110-550	145-550	220-550
Rated Input Voltage (V)	360	360	360	360
Start-up Voltage (V)	50	70	70	70
Max. Input Current (A)	14	14 x 2	14 x 2	14 x 2
Max. Short Current (A)	18	18 x 2	18 x 2	18 x 2
No. of MPP Tracker / No. of PV String	1/1	2/2	2/2	2/2
Input Connector Type	MC4	MC4	MC4	MC4
AC Output Data	HNS1000TL-1	HNS3000TL	HNS4000TL	HNS6000TL
Max. Output Power (W)	1100	3300	4400	6600
Nominal Output Power (W)	1000	3000	4000	6000
Max. Output Current (A)	6	15	20	28.7
Nominal Output Voltage (V)	L/N/PE, 220Vac, 230Vac, 240Vac			
Grid Voltage Range	180Vac-276Vac (According to local standard)			
Nominal Output Frequency (Hz)	50/ 60			
Grid Frequency Range	45-55Hz/54-66Hz (According to local standard)			
Output Power Factor	1 default (adjustable from 0.8 leading to 0.8 lagging)			
Output Current THD	<3%			
Efficiency	HNS1000TL-1	HNS3000TL	HNS4000TL	HNS6000TL
Max. Efficiency	97.50%	98.20%	98.20%	98.20%
Euro Efficiency	96.60%	97.80%	97.85%	97.92%
Protection	HNS1000TL-1	HNS3000TL	HNS4000TL	HNS6000TL
PV Reverse Polarity Protection	YES	YES	YES	YES
PV Insulation Resistance Detection	YES	YES	YES	YES
AC Short Circuit Protection	YES	YES	YES	YES
AC Over Current Protection	YES	YES	YES	YES
AC Over Voltage Protection	YES	YES	YES	YES
Anti-Islanding Protection	YES	YES	YES	YES
Residual Current Detection	YES	YES	YES	YES
Over Temperature Protection	YES	YES	YES	YES
Integrated DC switch	YES	YES	YES	YES
Surge Protection	Integrated (Type III)	Integrated (Type III)	Integrated (Type III)	Integrated (Type III)
Smart IV Curve Scanning	YES	YES	YES	YES
General Data	HNS1000TL-1	HNS3000TL	HNS4000TL	HNS6000TL
Dimensions (H x W x D, mm)	280 x 260 x 116	370 x 350 x 142		
Weight (kg)	6	11		
Protection Degree	IP65	IP65		
Enclosure Material	Aluminum	Aluminum		
Ambient Temperature Range (°C)	-25 to 60	-25 to 60		
Humidity Range	0-100%	0-100%		
Topology	Transformerless	Transformerless		
Communication Interface	RS485 / WiFi / Wire Ethernet	RS485 / WiFi / Wire Ethernet		
Cooling Concept	Convection	Convection		
Noise Emission (db)	<21	<28		
Night Power Consumption (W)	0.2	<1		
Max. Operation Altitude (m)	4000	4000		

INVERTER TRIFASE

POSSIBILITA' DI COLLEGAMENTO ALLA RETE (CEI-021)



ANTI-FLOW
Funzione blocco corrente in uscita.



INGRESSO MAX C/C
Potenza massima Pannelli 1,5 della potenza Inverter



PROTEZIONE
Protezioni Intelligenti



SMART
Scansione Intelligente della curva I-V



WIFI
Integrato



CONFIGURAZIONE
Semplice tramite WIFI



MODBUS

CARATTERISTICHE

- Wi-Fi
- Design compatto
- Molteplici protezioni intelligenti
- Compatibile con moduli bifacciali
- Monitoraggio a livello di stringa

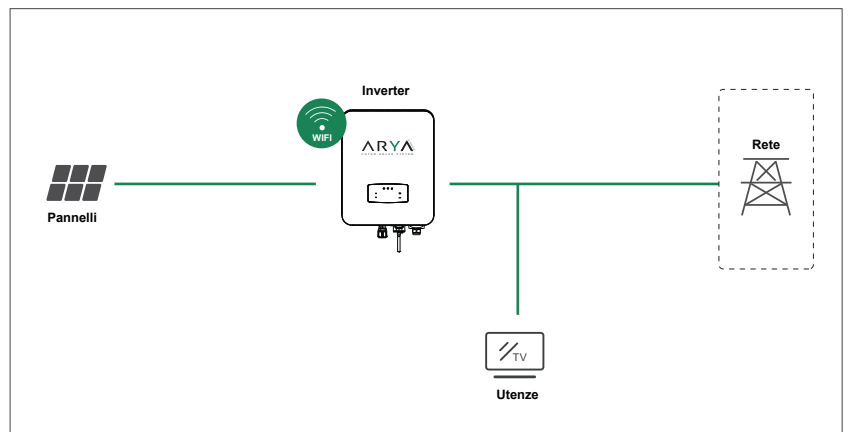

INVERTER MONOFASE

BNT010KTL / BNT015KTL / BNT020KTL / BNT030KTL
BNT040KTL / BNT050KTL / BNT060KTL

PV Input Data	BNT010KTL	BNT015KTL	BNT020KTL
Max. DC Power (W)	15000	22500	30000
Max. DC Voltage (V)	1100	1100	1100
MPPT Voltage Range (V)	150 - 1000	150 - 1000	150 - 1000
MPPT Full Power Voltage Range (V)	500 - 850	500 - 850	500 - 850
Rated Input Voltage (V)	620	620	620
Start-up Voltage (V)	150	150	150
Max. Input Current (A)	15 x 2	20 + 32	32 x 2
Max. Short Current (A)	25 x 2	30 + 48	48 x 2
No. of MPP Tracker / No. of PV String	2/2	2/3	2/4
Input Connector Type	MC4	MC4	MC4
AC Output Data	BNT010KTL	BNT015KTL	BNT020KTL
Max. Output Power (W)	11000	16500	22000
Nominal Output Power (W)	10000	15000	20000
Max. Output Current (A)	17	27	32
Nominal Output Voltage (V)	3P+N+PE / 3P+PE 230/ 400		
Grid Voltage Range	260Vac-519Vac (according to local standard)		
Nominal Output Frequency (Hz)	50/ 60		
Grid Frequency Range	45-55Hz/55-65Hz(according to local standard)		
Output Power Factor	1 default (adjustable from 0.8 leading to 0.8 lagging)		
Output Current THD	<3%		
Efficiency	BNT010KTL	BNT015KTL	BNT020KTL
Max. Efficiency	98.70%	98.70%	98.75%
Euro Efficiency	98.23%	98.23%	98.35%
Protection	BNT010KTL	BNT015KTL	BNT020KTL
PV Reverse Polarity Protection	YES	YES	YES
PV Insulation Resistance Detection	YES	YES	YES
AC Short Circuit Protection	YES	YES	YES
AC Over Current Protection	YES	YES	YES
AC Over Voltage Protection	YES	YES	YES
Anti-Islanding Protection	YES	YES	YES
Residual Current Detection	YES	YES	YES
Over Temperature Protection	YES	YES	YES
Integrated DC switch	YES	YES	YES
Surge Protection	Integrated (Type II)	Integrated (Type II)	Integrated (Type II)
Smart IV Curve Scanning	YES	YES	YES
Quick Arc Fault Circuit Interruption	Optional	Optional	Optional
General Data	BNT010KTL	BNT015KTL	BNT020KTL
Dimensions (H x W x D, mm)	510 x 370 x 192	510 x 370 x 192	535 x 370 x 192
Weight (kg)	15	17	19
Protection Degree	IP65	IP65	IP65
Enclosure Material	Aluminum	Aluminum	Aluminum
Ambient Temperature Range (°C)	-25 to 60	-25 to 60	-25 to 60
Humidity Range	0 - 100%	0 - 100%	0 - 100%
Topology	Transformerless	Transformerless	Transformerless
Communication Interface	RS485 / WiFi / Wire Ethernet	RS485 / WiFi / Wire Ethernet	RS485 / WiFi / Wire Ethernet
Cooling Concept	Intelligent fan cooling	Intelligent fan cooling	Intelligent fan cooling
Noise Emission (db)	<30	<40	<40
Night Power Consumption (W)	<1	<1	<1
Max. Operation Altitude (m)	≤4000	≤4000	≤4000

PV Input Data	BNT030KTL	BNT040KTL	BNT050KTL	BNT060KTL
Max. DC Power (W)	45000	60000	75000	90000
Max. DC Voltage (V)	1100	1100	1100	1100
MPPT Voltage Range (V)	200-1000	200-1000	200-1000	200-1000
MPPT Full Power Voltage Range (V)	500-850	500-850	500-850	500-850
Rated Input Voltage (V)	620	620	620	620
Start-up Voltage (V)	200	200	200	200
Max. Input Current (A)	38x3	38x3	40x3	38x4
Max. Short Current (A)	48x3	48x3	48x3	48x4
No. of MPP Tracker / No. of PV String	3/6	3/6	3/7	4/8
Input Connector Type	MC4	MC4	MC4	MC4
AC Output Data	BNT030KTL	BNT040KTL	BNT050KTL	BNT060KTL
Max. Output Power (W)	33000	44000	55000	66000
Nominal Output Power (W)	30000	40000	50000	60000
Max. Output Current (A)	48	65	80	96
Nominal Output Voltage (V)	3P+N+PE / 3P+PE 230/ 400			
Grid Voltage Range	260Vac-519Vac (according to local standard)			
Nominal Output Frequency (Hz)	50/ 60			
Grid Frequency Range	45-55Hz/55-65Hz (according to local standard)			
Output Power Factor	1 default (adjustable from 0.8 leading to 0.8 lagging)			
Output Current THD	<3%			
Efficiency	BNT030KTL	BNT040KTL	BNT050KTL	BNT060KTL
Max. Efficiency	98.50%	98.65%	98.80%	99.00%
Euro Efficiency	98.10%	98.25%	98.45%	98.50%
Protection	BNT030KTL	BNT040KTL	BNT050KTL	BNT060KTL
PV Reverse Polarity Protection	YES	YES	YES	YES
PV Insulation Resistance Detection	YES	YES	YES	YES
AC Short Circuit Protection	YES	YES	YES	YES
AC Over Current Protection	YES	YES	YES	YES
AC Over Voltage Protection	YES	YES	YES	YES
Anti-Islanding Protection	YES	YES	YES	YES
Residual Current Detection	YES	YES	YES	YES
Over Temperature Protection	YES	YES	YES	YES
Integrated DC switch	YES	YES	YES	YES
Surge Protection	Integrated (Type II)	Integrated (Type II)	Integrated (Type II)	Integrated (Type II)
Smart IV Curve Scanning	YES	YES	YES	YES
Quick Arc Fault Circuit Interruption	Optional	Optional	Optional	Optional
General Data	BNT030KTL	BNT040KTL	BNT050KTL	BNT060KTL
Dimensions (H x W x D, mm)	712 x 427 x 232	712 x 427 x 232	712 x 427 x 232	712 x 427 x 232
Weight (kg)	42	43	45	51
Protection Degree	IP65	IP65	IP65	IP65
Enclosure Material	Aluminum	Aluminum	Aluminum	Aluminum
Ambient Temperature Range (°C)	-25 to 60	-25 to 60	-25 to 60	-25 to 60
Humidity Range	0-100%	0-100%	0-100%	0-100%
Topology	Transformerless	Transformerless	Transformerless	Transformerless
Communication Interface	RS485/WIFI/Wire Ethernet	RS485/WIFI/Wire Ethernet	RS485/WIFI/Wire Ethernet	RS485/WIFI/Wire Ethernet
Cooling Concept	Intelligent Fan Cooling	Intelligent Fan Cooling	Intelligent Fan Cooling	Intelligent Fan Cooling
Noise Emission (db)	<51	<51	<55	<55
Night Power Consumption (W)	<1	<1	<1	<1
Max. Operation Altitude (m)	≤4000	≤4000	≤4000	≤4000